



Statics

By : Majid Roghaei

Home Work # 3

Mehr 93-94



STRUCTURAL ANALYSIS And MACHINES

Analysis of a Truss; Method of Joints

۱. نیرو در تمام اعضا را تعیین نمایید.

- Determine forces of all members

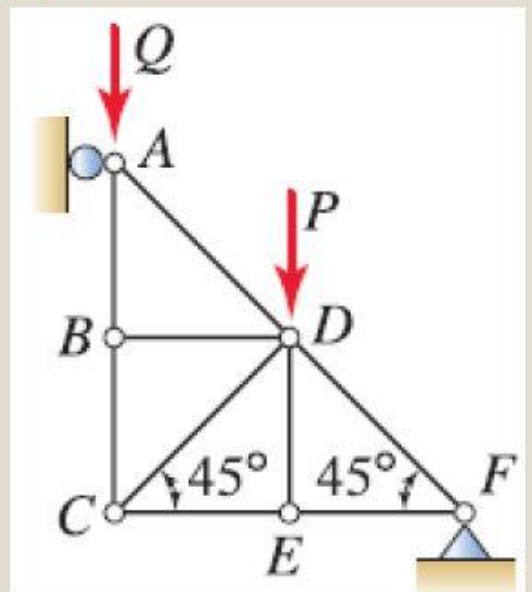



۲. نیرو در تمام اعضا را تعیین نمایید.

- Determine forces of all members

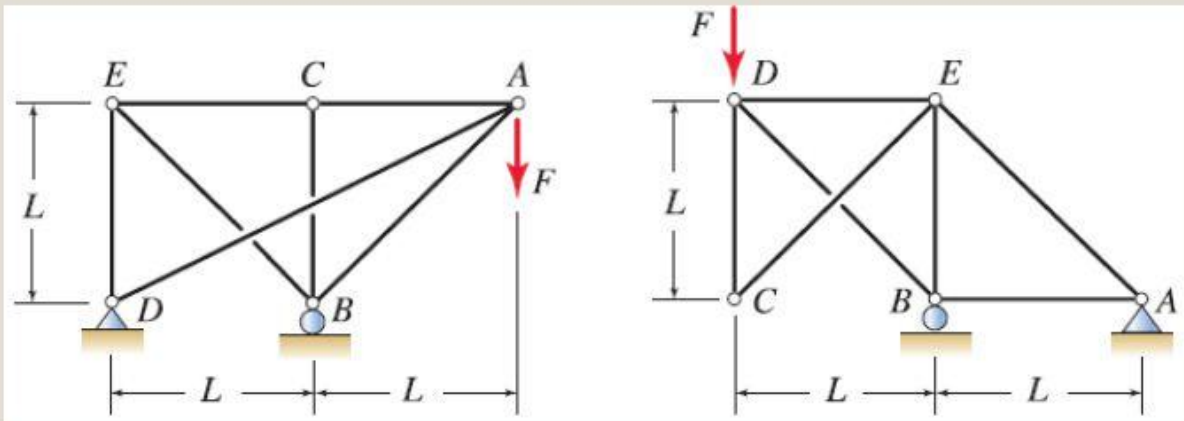

۳. نیرو در تمام اعضا را تعیین نمایید.

- Determine forces of all members

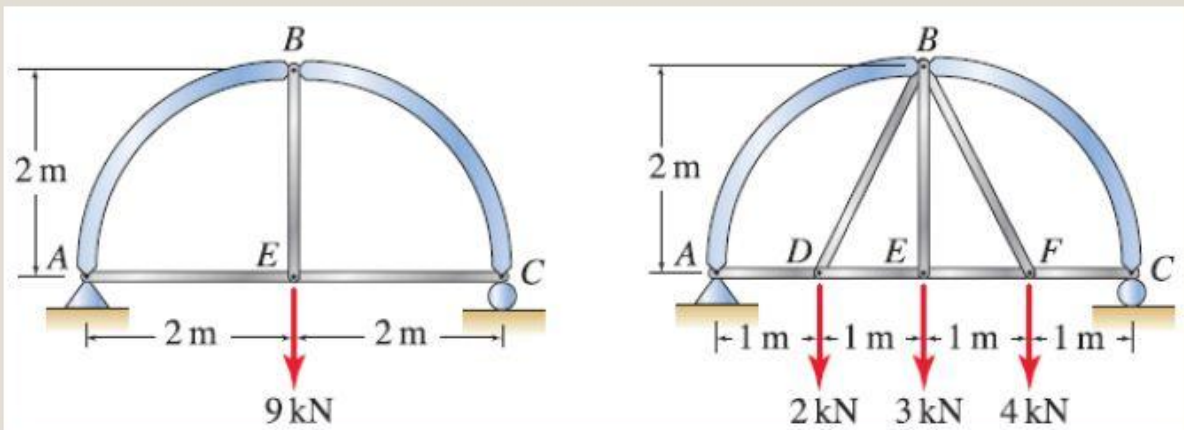



۴. نیرو در تمام اعضا را تعیین نمایید.

- Determine forces of all members

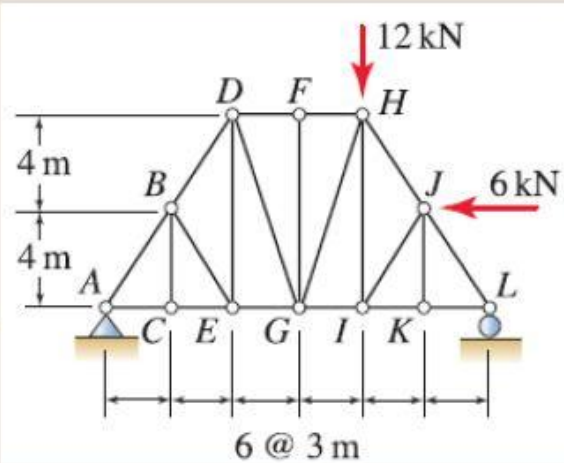
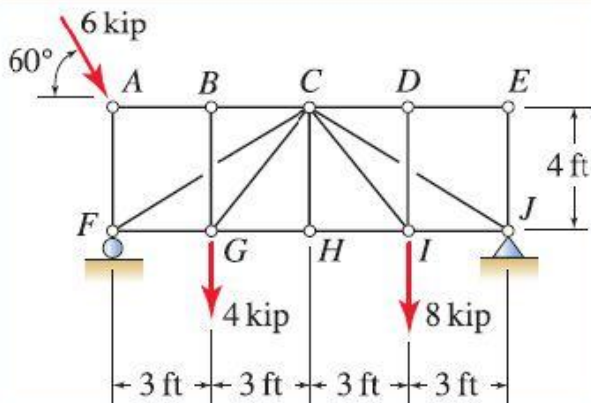

Truss Structures; Method of Sections

- $FG=?$

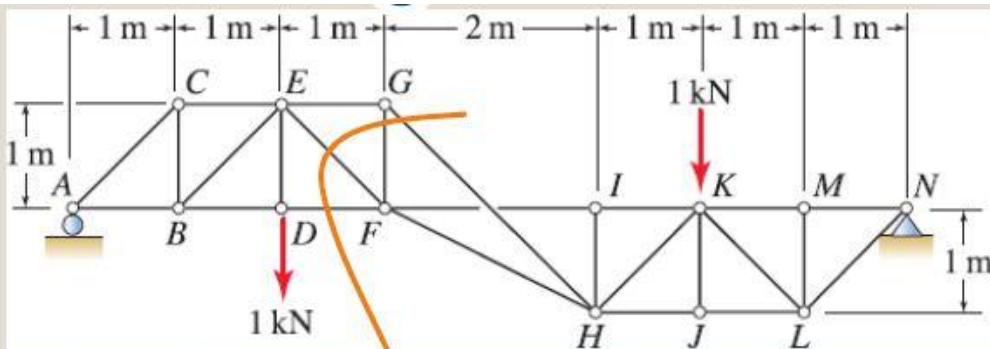

- Moment about F \rightarrow HG
- Force balance at G \rightarrow FG



• $BD=?$

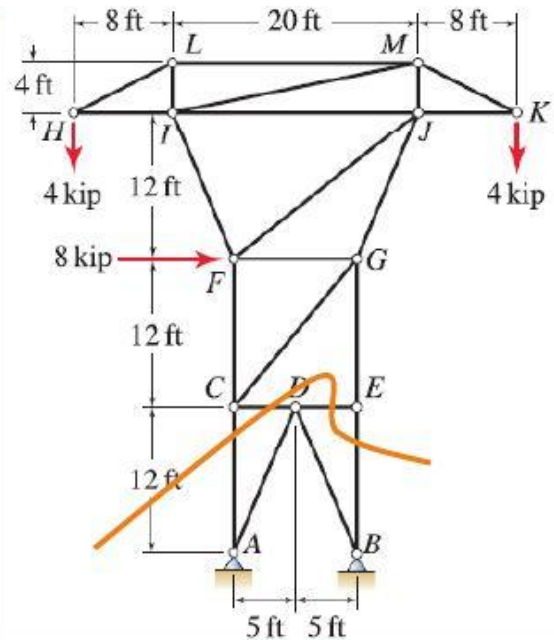

• $HJ=?$

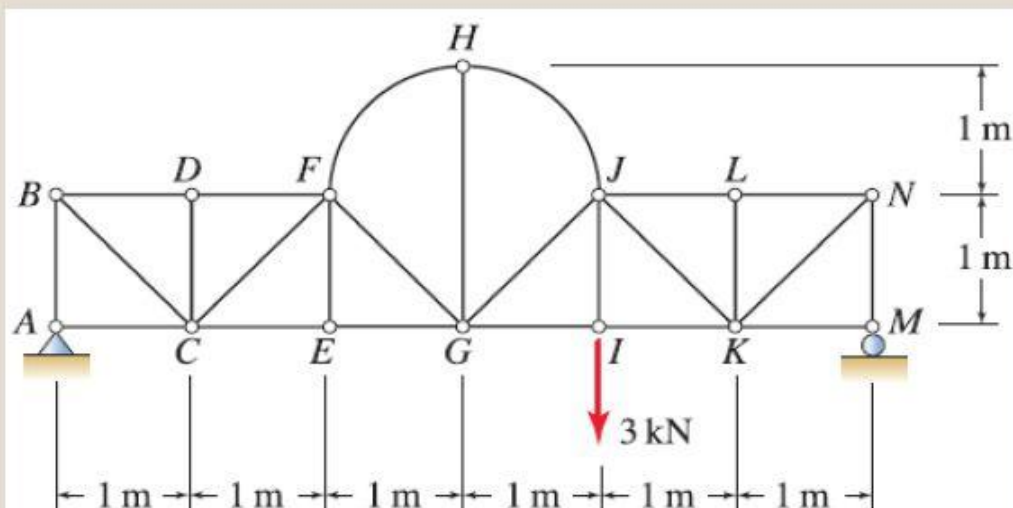



Statically Determinate or Indeterminate

معین استاتیکی یا نا معین استاتیکی؟

- Statically determinate or indeterminate?

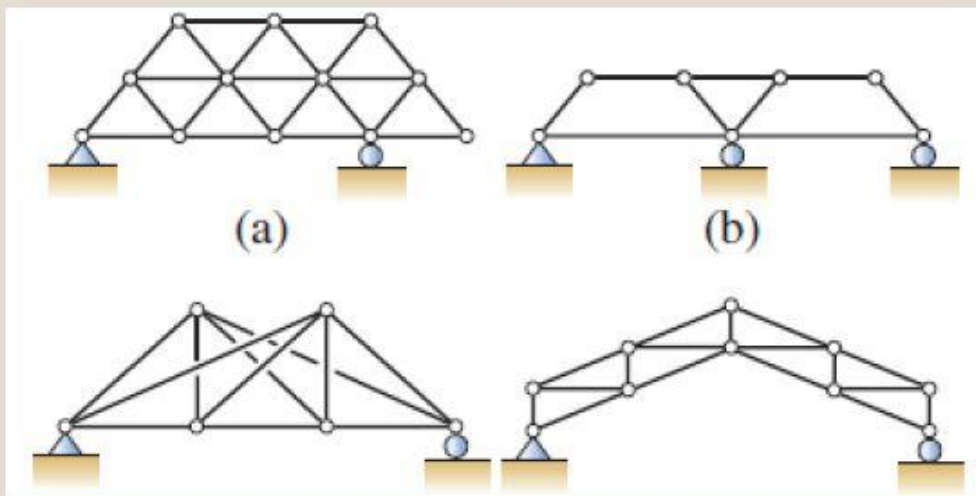

- Statically determinate or indeterminate?

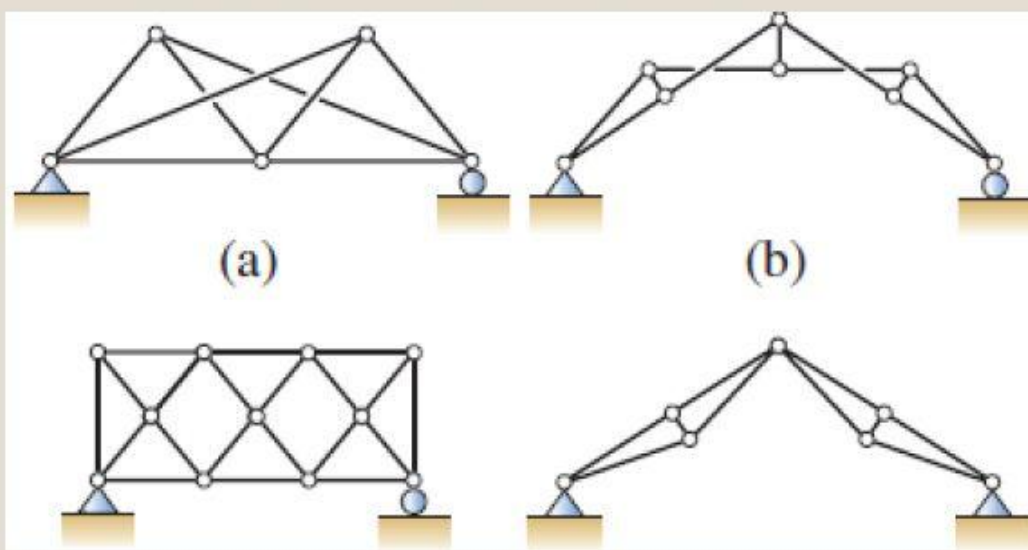



- $P=1, Q=2, R=3$
- Determinate or Indeterminate?
- Use Section method for AD

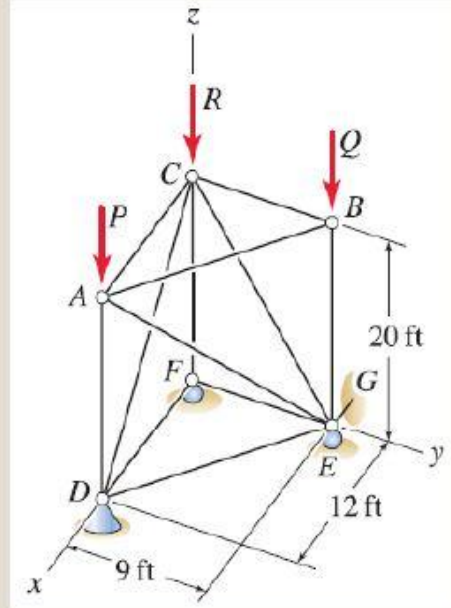

موفق و شاد باشید

مجید رقائی